

Initial Plans for 31 Broadway

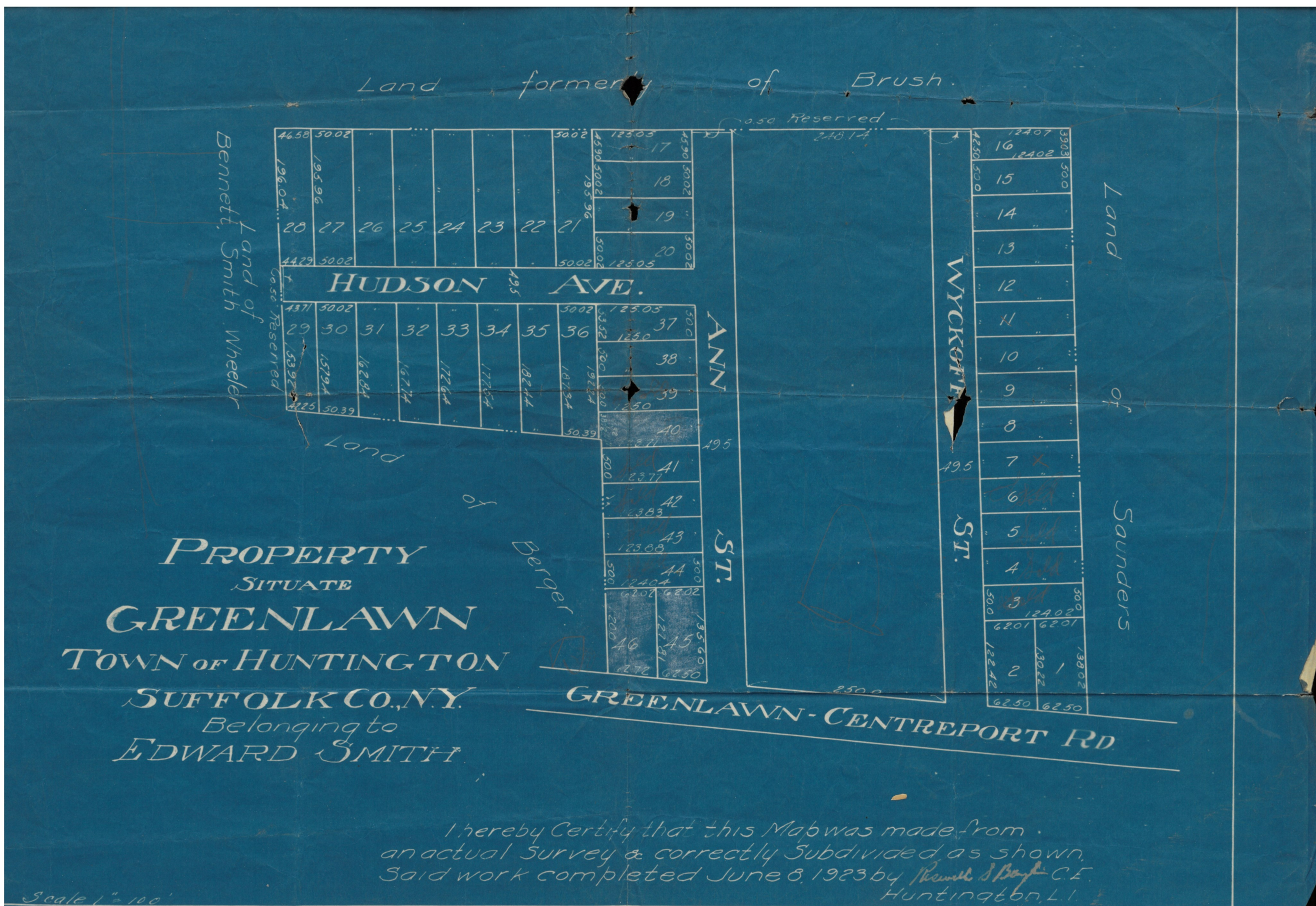

Survey and Subdivision of the *Property Situate Greenlawn Town of Huntington Suffolk Co., N.Y. Belonging to Edward Smith*

C. around the 1920s

Left is a blueprint subdividing Berger, Smith-Wheeler, Brush, and Saunders farmland into residential plots. The empty rectangle in the center outlines the Greenlawn/Broadway School plot. Notice that Broadway is called “Greenlawn-Centreport Road.” Hudson Avenue, now Gaines Avenue, was most likely named after Hudson the Blacksmith, who had a shop on the corner of now Broadway and Smith.

Map Showing The Greenlawn School District—Known as District N°6— of the Town of Huntington. Suff. Co., N. Y.

by Russell S. Baylis

Dated October 1923

“Note - Width of Roads Exaggerated”

Notice that Broadway is the “Main Highway From Greenlawn to Centreport.” Importantly, the shaded portion between Ann Street and Wycoff Street is labeled “New School Site.”

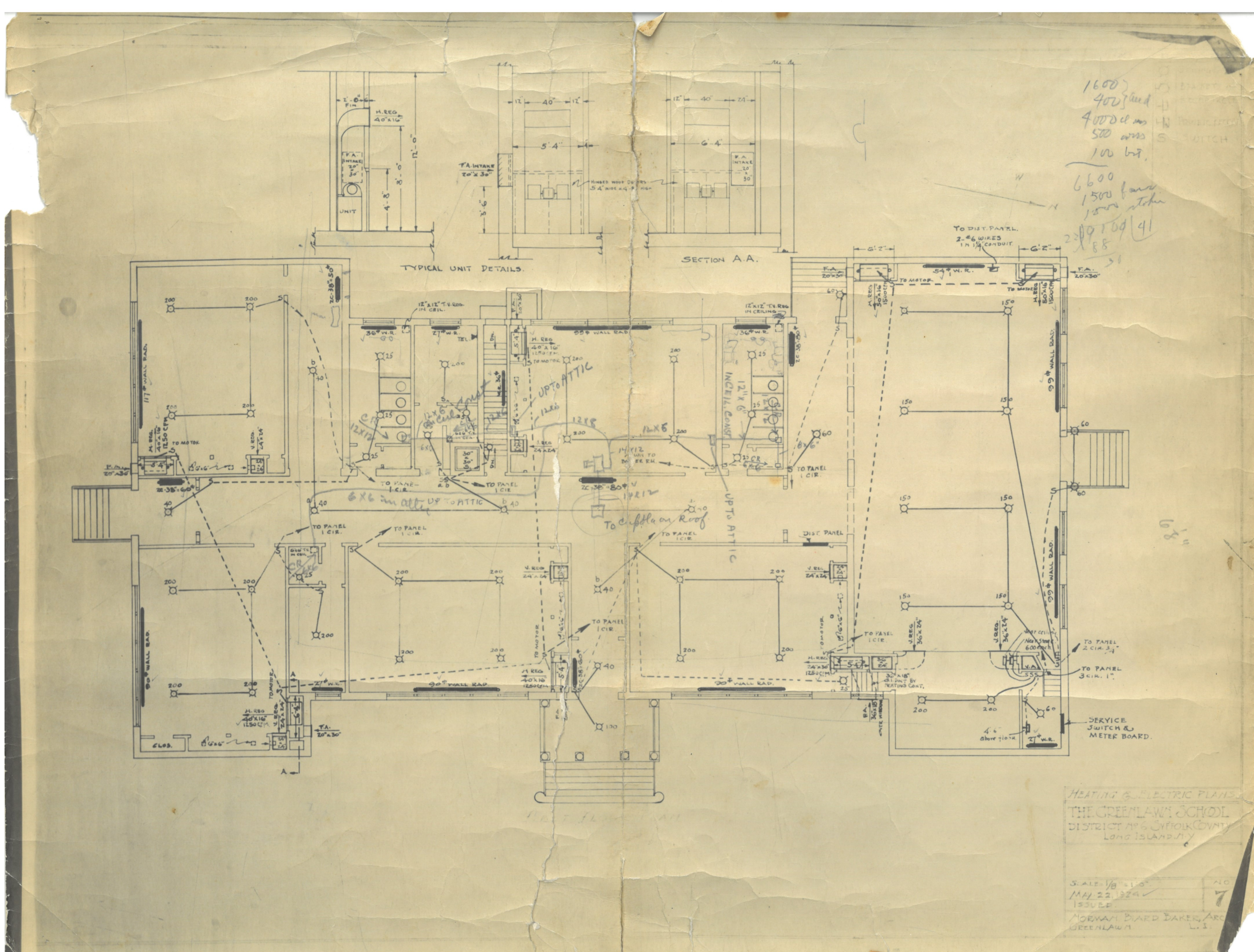

Heating & Electric Plans

The Greenlawn School

District N°6, Suffolk County, Long Island, N. Y. Scale = 1/8" = 1'0"

Dated May 22, 1924

Norman Biard Baker, Architect, Greenlawn L.I.

When Baker was designing the school, he left room for expansions. This plan shows the first iteration of the school, which includes what is now (from top left to right): the library staff meeting room, GCHA office, Studio 31, book store, small meeting room, large meeting room, and kitchen. The Broadway entrance was secondary to the side entrance where the students lined up to come in every morning.